

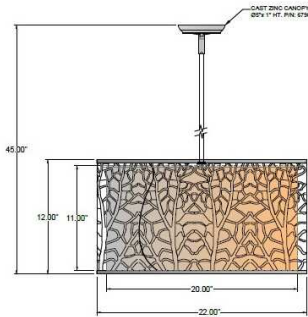

1233 W St. Georges Ave., Linden, NJ 07036 \* 908-925-7500\* 908-925-9240

**SPECIFICATIONS**

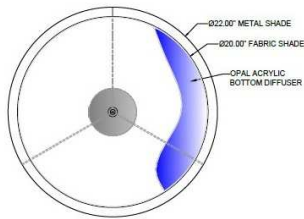

<b>PD-5855-115-01-862B-SVPC</b>	<b>Pendant</b>
Model Number	Type
<b>Branches Laser Cut Drum</b>	
Name	Project
	QTY



**Describe Special Modifications**

**Warranty:** 1-Year Limited Warranty.  
Complete warranty terms located at: [www.litetopslampshades.com](http://www.litetopslampshades.com)

CATALOG NUMBER						
Example: PD-5855-115-01-862B-SVPC -LEDMOD2700K-120V						
Hardware Style Code	Fabric/Material/Color Options	Series Code	Finish Options	Lamping	Voltage	Other Size Options
PD-5855	<b>Outer</b> LCM - Laser Cut Metal <b>Inner</b> 115-01 White Linen 115-05 Off White Linen 115-62 Black Linen 115-96 Red Linen 124-70 Teal Pongee Silk 136-50 Platinum Silkscreen 143-26 Geneva Linen Ash  More options at <a href="http://www.litetopslampshades.com">www.litetopslampshades.com</a>	862B	<b>APW</b> - Aged Pewter <b>GLWH</b> - Gloss White <b>MBK</b> - Matte Black <b>OB</b> - Oil Rubbed Bronze <b>SN</b> - Satin Nickel <b>SVPC</b> - Silver Powder Coat <b>OCB</b> - Oculux Bronze	<b>E26X3</b> - 3 Medium Based <b>GU24X3</b> - 3GU24 CFL <b>LEDMOD2700K</b> - LED Module, 2700K, 2600 LM Per Board <b>LEDMOD3000K</b> - LED Module, 3000K, 2680 LM Per Board <b>LEDMOD3500K</b> - LED Module, 3500K, 2720 LM Per Board <b>LEDMOD4000K</b> - LED Module, 4000K, 2820 LM Per Board (Accepts One Board)	120V 120V 277V 277V	